

**GENERAL NOTES**

The information contained in this drawing is representational and has been compiled, from a dimensional survey only and does not warrant nor certify the structure of the buildings or neighboring structures at the time of construction.

The contractor is to visit the site to make himself acquainted with the building's and surroundings and undertake any investigation work or make all allowances to ensure that a full and final quotation for the works will be submitted, taking into account all eventualities.

All work and working practices on the site shall be carried out in accordance with the above and to ensure that there is no risk to the site operatives, visitors or public. The contractor is to include all preliminary allowances to cover the prevention of accidents and injury.

All workmanship and materials to comply with current relevant Building Regulations, British Standards and Codes of Practice. All materials to be stored, mixed and fixed in accordance with manufacturers instructions and recommendations.

All provisions for temporary means of support and regulations for Health and Safety at work to be applied.

All works to be carried out to the complete satisfaction of the Local Authority Building Control Officer.

All works to be carried out in strict accordance with HSE guidance and the CDM regulations.

DO NOT SCALE the contractor must verify all dimensions prior to commencing shop drawings or works on site.

Exact setting out and final levels to be agreed on site.

To be read in conjunction with approved planning drawings

**COPYRIGHT:**  
This drawing is the copyright of Cannon Clarke Architects, and must not be copied, re-issued or loaned without prior written consent of Cannon Clarke Architects. Any discrepancies and or conflicting information implied or specified is to be notified to Cannon Clarke Architects prior to construction on site. Construction should only proceed from drawings issued for construction purposes unless prior written consent is obtained. Should any site personnel, or those employed to carry out the works on their behalf, choose alternative materials or components to those specified on Cannon Clarke Architects drawings without prior written agreement then they do so entirely at their own risk.

**PARK HOME KEY**

SYMBOL	NAME	WIDTH (m <sup>2</sup> )	LENGTH (m <sup>2</sup> )	NO.
	Small	6.7	12.2	41
	Medium	6.7	13.4	293
	Large	6.7	15.8	34
<b>Total</b>				<b>368</b>

**INFRASTRUCTURE KEY**

SYMBOL	NAME	WIDTH (m <sup>2</sup> )	LENGTH (m <sup>2</sup> )	SURFACE
	Primary	4.8	--	Tarmac
	Secondary	4.8	--	Gravel

**BOUNDARY KEY**

- Application Site Boundary
- Bus shelter
- Sheffield Cycle Park

**MISCELLANEOUS KEY**

- Waste & Recycle Station (2no. 1100 litre eurobins + 3no. 240 litre bins)
- proposed tree
- proposed hedge

**NOTES**

- Fire Points to be positioned facing the road within 30 meters of any park home
- Lodge outline symbols do not include the front porch. Please refer to drawing PL.011 for further detailed information.
- EVC (Electric Vehicle charging) - ducting and infrastructure to be installed for every parking space + drive - ready to retrofit with minimal disruption.

**SCHEMATIC LAYOUT AND DIMENSIONS**

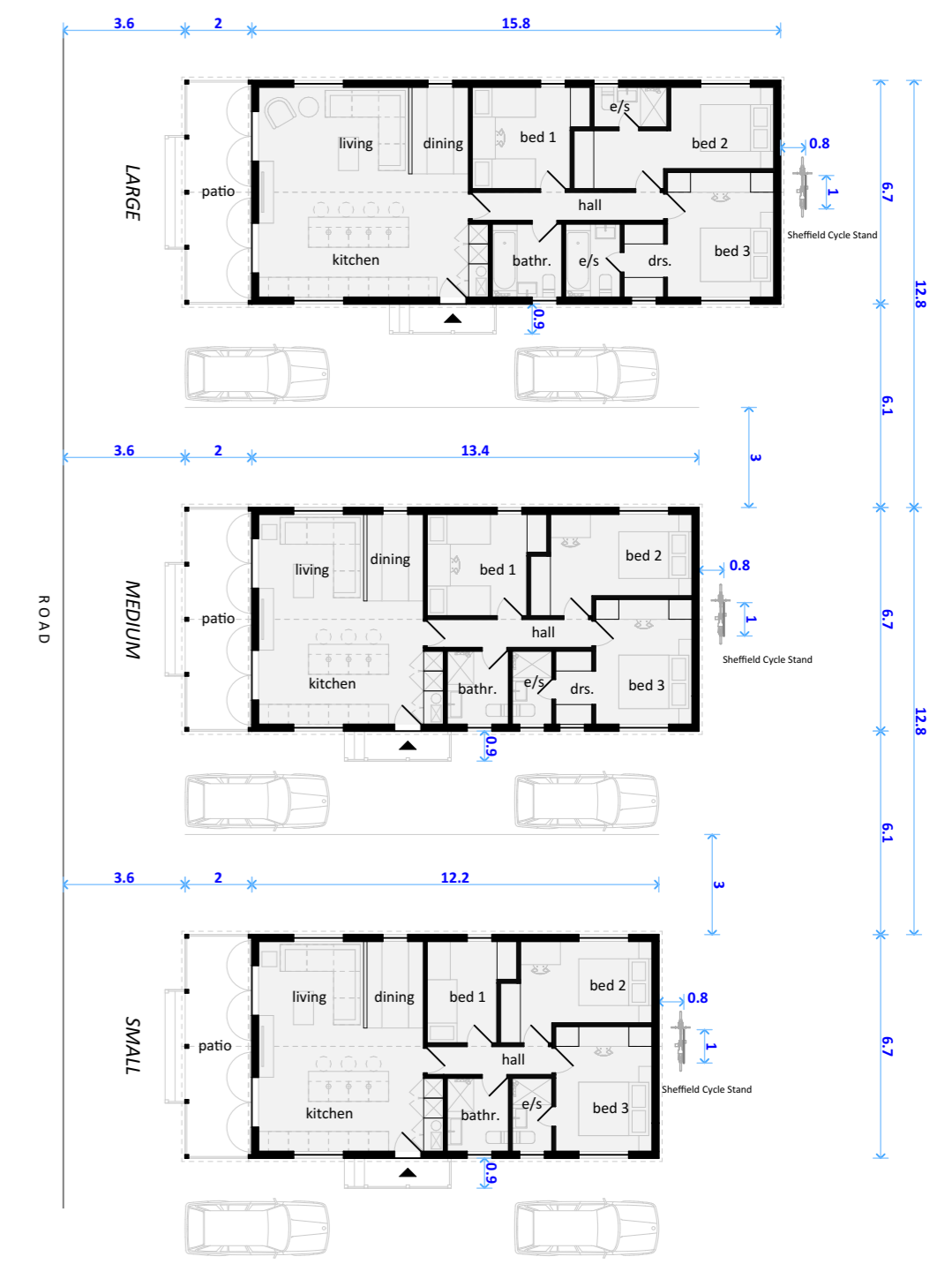

P10	27/05/2022	addressing client's comments
P9	24/05/2022	addressing client's comments
P8	11/04/2022	addressing client's comments
P7	24/02/2022	addressing client's comments
P6	23/02/2022	addressing client's comments
P5	17/02/2022	addressing planning and client's comments
P4	06/01/2022	addressing planning comments, with the addition of a relevant dimensions, provision for public EVC's and bicycles, and a minibus stop with shelter
P3	16/07/2021	issued for planning
P2	13/07/2021	issued for information - work in progress
P1	08/07/2021	issued for information - work in progress
no	date	revision

**CANNON CLARKE ARCHITECTS**

Ground Floor Chapel 01603 567415 Jonathan Scott hall Thorpe Road Norwich NR1 1UH www.cannonclarkearchitects.co.uk

Ritz Resorts - Holiday Park	job
Address	Adlethorpe, Lincolnshire
Site Plan as Proposed	PLANNING
drawing title	status
1:1250, 1:200@A1	17/12/2021
scale	date
RG / SS / RA	AC
drawn by	checked by
1224	PL.010
job number	drawing reference
	revision

This document and its design content is copyright ©. It shall be read in conjunction with all other associated project information including models, specifications, schedules and related consultants documents. Do not scale from documents. All dimensions to be checked on site. Immediately report any discrepancies, errors or omissions on this document to the Originator. If in doubt ASK.

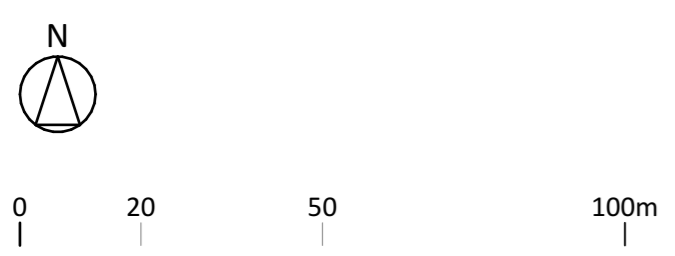

DRAFT - For design consultation purposes only  
Not to be used for planning purposes